



**Electrolux**  
PROFESSIONAL

**Modular Cooking Range Line  
thermaline 85 - 800 mm Electric  
Warming Cabinet with 2 doors, GN  
conform, 1 Side (H2)**

ITEM #

MODEL #

NAME #

SIS #

AIA #



**588653**  
**(MB4HCAHOAO)**

Electric Warming Cabinet with 2 doors, one-side operated, GN - H2

### Short Form Specification

**Item No.**

800 mm wide warming cabinet with 2 doors. Internal frame for heavy duty sturdiness in stainless steel. Flat surface construction, easily cleanable. Temperature in the cabinet can be set through thermostat, up to a maximum of 110 °C. Cabinet storage space accepts GN 1/1 containers.

IPX5 water resistant certification.

Configuration: One side operated freestanding base, hygienic class H2.

### Main Features

- All major components may be easily accessed from the front.
- THERMODUL connection system creates a seamless work top when units are connected to each other thus avoiding soil penetrating vital components and facilitating the removal of units in case of replacement or service.
- Temperature in the cupboard can be set through a thermostat to suit different requirements. The maximum temperature is 110° C.
- Unit constructed according to DIN 18860\_2 with 70 mm recessed plinth.
- Unit can be installed below modular top appliances, designed to keep plates warm.

### Construction

- IPX5 water resistance certification.
- 2 mm top in 1.4301 (AISI 304).
- Flat surface construction with minimal hidden areas to easily clean all surfaces
- Storage space in the base of the appliance accepts GN1/1 containers.
- Internal frame for heavy duty sturdiness in stainless steel.

### Optional Accessories

- Stainless steel front kicking strip, 800mm width PNC 912634 ☐
- Stainless steel side kicking strip left and right, wall mounted, 850mm width PNC 912659 ☐
- Stainless steel side kicking strip left and right, back-to-back, 1700mm width PNC 912662 ☐
- Stainless steel side panel, 850x700mm, right side, against wall PNC 913003 ☐
- Stainless steel side panel, 850x700mm, left side, against wall PNC 913004 ☐
- Perforated shelf for warming cabinets and cupboard bases (one-side operated TL80-85-90 and two-side operated for TL80) PNC 913234 ☐
- Energy optimizer kit 14A - factory fitted PNC 913244 ☐
- Side reinforced panel only in combination with side shelf, for against the wall installations, right PNC 913261 ☐
- Side reinforced panel only in combination with side shelf, for against the wall installations, left PNC 913262 ☐
- Shelf fixation for TL80-85-90 one-side operated, TL80 two-side operated PNC 913281 ☐

**APPROVAL:**



Experience the Excellence  
[www.electroluxprofessional.com](http://www.electroluxprofessional.com)



**Electrolux**  
PROFESSIONAL

**Modular Cooking Range Line  
thermaline 85 - 800 mm Electric Warming  
Cabinet with 2 doors, GN conform, 1 Side (H2)**

- Stainless steel dividing panel, 850x700mm, (it should only be used between Electrolux Professional thermaline Modular 85 and thermaline C85) PNC 913670 ☐
- Stainless steel side panel, 850x700mm, flush-fitting (it should only be used against the wall, against a niche and in between Electrolux Professional thermaline and ProThermetic appliances and external appliances - provided that these have at least the same dimensions) PNC 913686 ☐



**Modular Cooking Range Line  
thermaline 85 - 800 mm Electric Warming Cabinet with 2 doors, GN  
conform, 1 Side (H2)**  
The company reserves the right to make modifications to the products  
without prior notice. All information correct at time of printing.

2025.04.18



**Electrolux**  
PROFESSIONAL

**Modular Cooking Range Line**  
**thermaline 85 - 800 mm Electric Warming**  
**Cabinet with 2 doors, GN conform, 1 Side (H2)**

Front

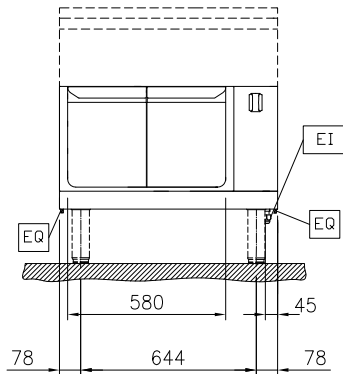

Side

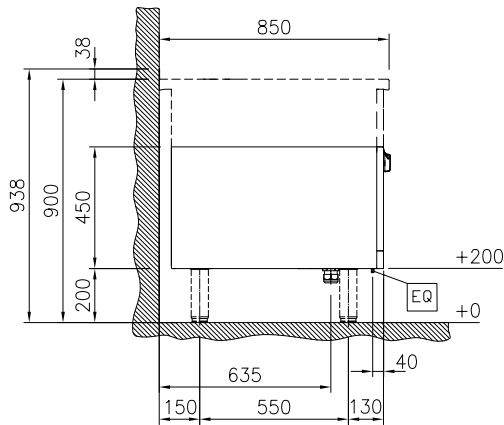

EI = Electrical inlet (power)

Top

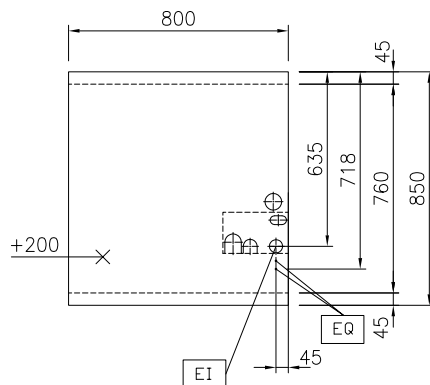

**Key Information:**

External dimensions, Width:

588653 (MB4HCAHOAO) 800 mm

External dimensions, Depth: 850 mm

External dimensions, Height: 450 mm

Cupboard Cavity Dimensions (width): 580 mm

Cupboard Cavity Dimensions (height): 330 mm

Cupboard Cavity Dimensions (depth): 715 mm

Cabinet temperature range: 30-110 °C

Net weight: 29 kg

**Sustainability**

Current consumption: 5 Amps



Modular Cooking Range Line  
thermaline 85 - 800 mm Electric Warming Cabinet with 2 doors, GN  
conform, 1 Side (H2)  
The company reserves the right to make modifications to the products  
without prior notice. All information correct at time of printing.

2025.04.18